

LinTronic

<http://www.lintronic.dk>

HANTAREX / SHARP



Hantarex SH_Protocol_rev4.pdf - Adobe Reader

File Edit View Document Tools Window Help

5 / 6 133% Find

Appendix

RS-232C port specifications

PC Control of the System

- When a program is set, the display can be controlled from the PC using the RS-232C terminal. The input signal (PC/video) can be selected, the volume can be adjusted and various other adjustments and settings can be made, enabling automatic programmed playing.
- Attach an RS-232C cable cross-type (commercially available) to the supplied Din/D-sub RS-232C for the connections.

NOTE

- This operation system should be used by a person who is accustomed to using PCs.

Communication conditions

Set the RS-232C communications settings on the PC to match the display's communications conditions. The display's communications settings are as follows:

Baud rate:	9,600 bps
Data length:	8 bits
Parity bit:	None
Stop bit:	1 bit
Flow control:	None

Communication procedure

Send the control commands from the PC via the RS-232C connector. The Display operates according to the received command and sends a response message to the PC. Do not send multiple commands at the same time. Wait until the PC receives the OK response before sending the next command.

Example: Power OFF

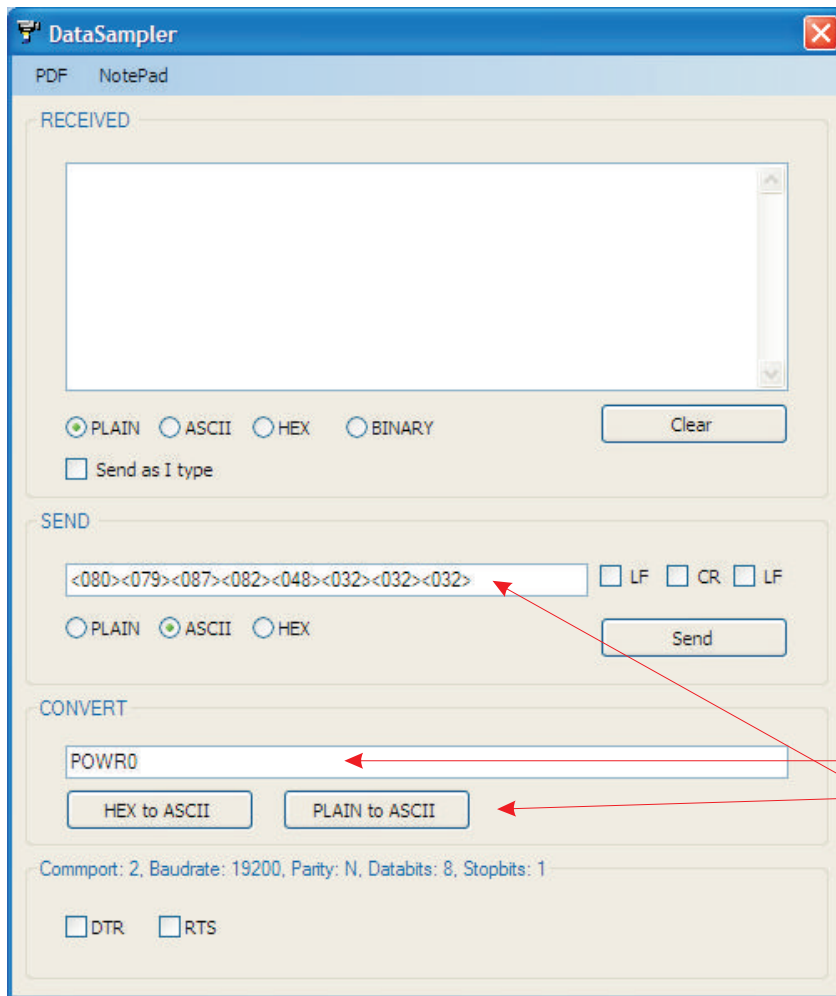

Enter command (POWR0---)
 Click PLAIN TO ASCII
 Copy the first 6 ascii numbers
 below marked blue.
 Forget the last 2 ascii numbers
 below marked red.

`<080><079><087><082><048><032><032><032>`

insert the 6 ascii numbers into LinTronic format in the CommandList:

769008080079087082048032=POWER OFF

Example: Direct channel 34

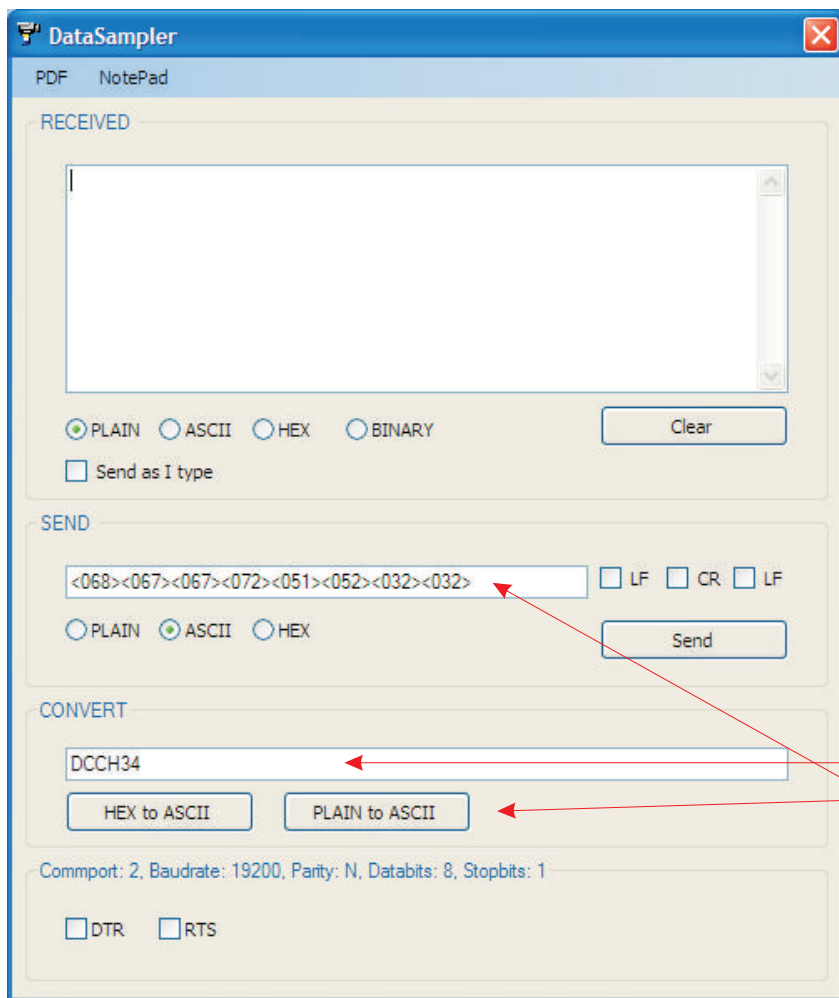

Enter command (DCCH34--)
 Click PLAIN TO ASCII
 Copy the first 6 ascii numbers
 below marked blue.
 Forget the last 2 ascii numbers
 below marked red.

<068><067><067><072><051><052><032><032>

insert the 6 ascii numbers into LinTronic format in the CommandList:

769008068067067072051052=DIRECT CHANNEL 34

Hantarex SH_Protocol_rev4.pdf - Adobe Reader
 File Edit View Document Tools Window Help
 6 / 6 133% Find

Commands

CONTROL ITEM	COMMAND	PARAMETER	CONTROL CONTENTS
POWER SETTING	P O W R 0	-	POWER OFF (STANDBY)
	I T G D -	-	INPUT SWITCHING (TOGGLE)
	I T V D -	-	TV (CHANNEL FIXED)
	I A V D *	-	INPUT1 - 5 (1 - 5)
CHANNEL	D C C H *	-	TV DIRECT CHANNEL (1 - 99)
	C H U P -	-	CHANNEL UP
	C H D W -	-	CHANNEL DOWN
	I N P 1 0 -	-	INPUT1 (CVBS)
INPUT SELECTION B	I N P 1 1 -	-	INPUT1 (RGB)
	I N P 2 0 -	-	INPUT2 (CVBS)
	I N P 2 1 -	-	INPUT2 (YC)
	I N P 3 0 -	-	INPUT3 (CVBS)
	I N P 3 1 -	-	INPUT3 (YC)
	I N P 3 2 -	-	INPUT3 (RGB)
	I N P 3 3 -	-	INPUT3 (COMPONENT)
	I N P 4 0 -	-	INPUT4 (AUTO)
	I N P 4 1 -	-	INPUT4 (S-VIDEO)
	I N P 4 2 -	-	INPUT4 (VIDEO)
	I N P 5 0 -	-	DIGITAL PC
	I N P 5 1 -	-	ANALOGUE PC
I N P 5 2 -	-	DIGITAL AV	
I N P 5 3 -	-	ANALOGUE AV	
AV MODE SELECTION	A V M D 0 -	-	TOGGLE

CONTROL ITEM	COMMAND	PARAMETER	CONTROL CONTENTS
POSITION	H P O S *	*	H-POSITION (AV) (-10 - +10)
	H P O S *	*	H-POSITION (PC) (0 - 180)
	V P O S *	*	V-POSITION (AV) (-20 - +20)
	V P O S *	*	V-POSITION (PC) (0 - 100)
WIDE MODE	C L C K *	*	CLOCK (0 - 180)
	P H S E *	*	PHASE (0 - 40)
	W I D E 0 -	-	TOGGLE (AV)
	W I D E 1 -	-	NORMAL (AV)
	W I D E 2 -	-	ZOOM 14.9 (AV)
	W I D E 3 -	-	PANORAMA (AV)
	W I D E 4 -	-	FULL (AV)
	W I D E 5 -	-	CINEMA 16.9 (AV)
	W I D E 6 -	-	CINEMA 14.9 (AV)
	W I D E 7 -	-	NORMAL (PC)
	W I D E 8 -	-	CINEMA (PC)
	W I D E 9 -	-	FULL (PC)
MUTE	W I D E 1 0 -	-	DOT BY DOT (PC)
	M U T E 0 -	-	TOGGLE
DOLBY VIRTUAL	M U T E 1 -	-	MUTE
	M U T E 2 -	-	MUTE OFF
AV MODE SELECTION	A C D V 0 -	-	TOGGLE
	A C D V 1 -	-	ON
	A C D V 2 -	-	OFF