

# LinTronic

<http://www.lintronic.dk>

## Connecting AutoMute Telephone Relay

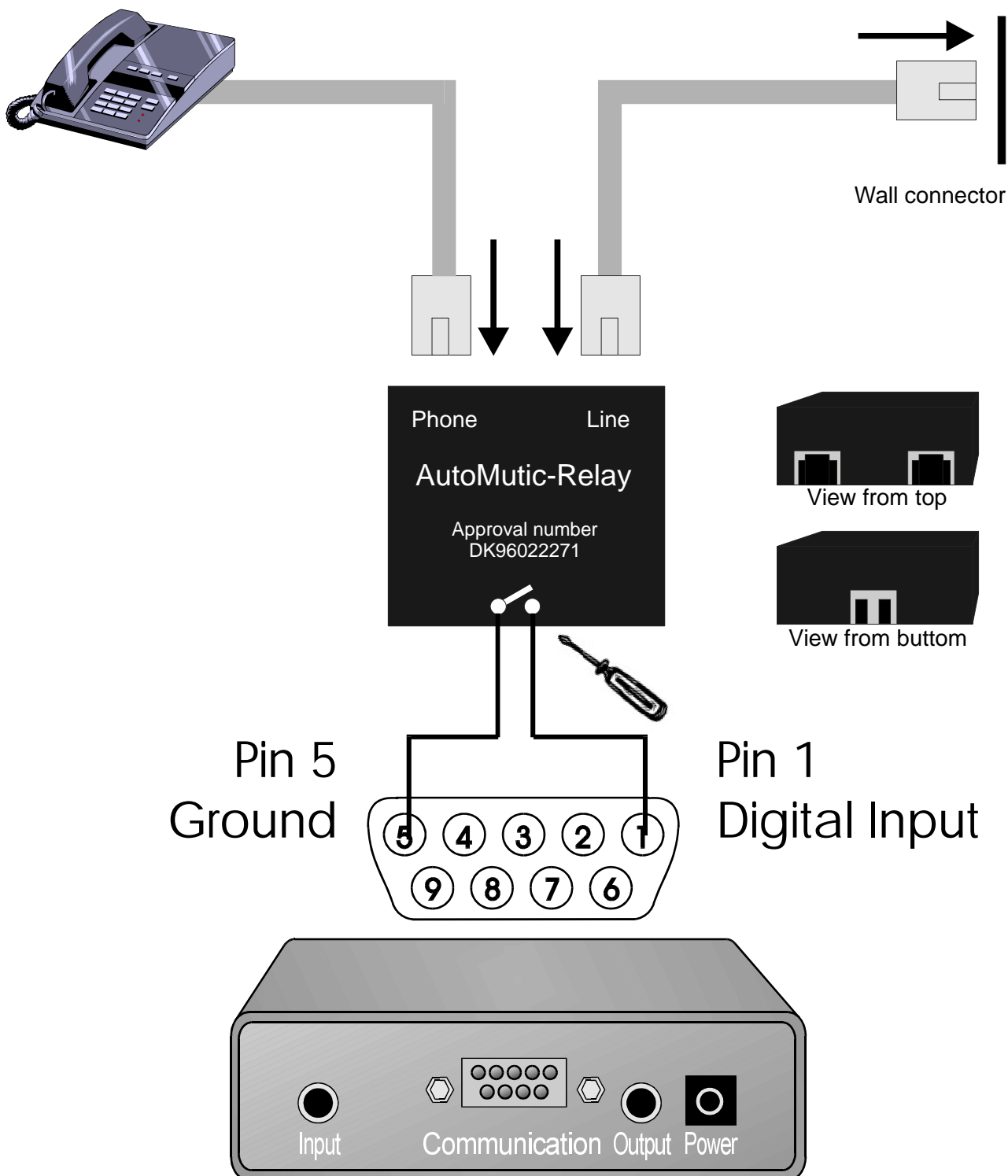

# LinTronic

<http://www.lintronic.dk>

Note:

Use our SETUP PC software to:

- program the digital input to work as TelephoneRelay input
- store the PhoneLineCodes for Idle and Busy conditions
- you may copy any of the codes from our internet database
- or copy the code from your own remote control

By storing the mute code from your stereo or TV,  
The TableTop product automatically mutes the sound:

- when the phone rings, or
- when you make an outgoing phone call

Automatically turns On the sound (send mute again)

- when ringing stops
- when you finish the phone call

Also sends changes of PhoneLine status to the computer

- when phone is ringing (can be used to count ringing)
- when phone line is busy (conversation)
- when phone line is idle

For more information see our web-site:

Download section

Command Reference List

Command 027 (InputMode)

Command 910 (PhoneLineStaus)